

DDA COMMUNITY HALL, SRINIWASPURI

PRODUCED BY AN AUTODESK EDUCATIONAL PRODUCT

FIRST & SECOND FLOOR PLAN

THIRD FLOOR PLAN

VERIFIED

This proposal was considered in the Meeting held on 17.5.2013

Meeting No. 314

Vide Item No. 92:2013

Dy. Director (Coordn.)

DDA SOUTH ZONE

SPECIFICATIONS

FLOORING: KITCHEN: IMPERMEABLE FLOORING WITH GRATE AS PER DRAWING. RESTROOM: 20 CM POLISHED RED STONE FLOORING. BATH & W.C.: 15 CM POLISHED GRAY FLOOR TILES CHECKER.

FINISHING: EXTERIOR: WALLS: PLASTER WITH EXTENDED WEATHER COAT. ROOFING: TERRACE: BRICK BAT COAM TREATMENT WITH BRICK TILE FLOORING.

DOOR: WINDOW: FRAME: POWDER COATED ALUMINIUM SECTIONS AS PER BIDDY WINDOW DRAWING.

KITCHEN: METALS: COUNTER: SLAB: 20 MM THICK GRANITE/ APPROVED SHADE & QUALITY.

CABINET: 18 MM FIRE LAMINATED PLY BOARD WITH RED OAK/ STAINLESS STEEL ACCESSORIES AS PER APPROVED SHADE & NAME.

METAL WORK: STAIRCASE: RAILING: STAINLESS STEEL (20Y) AS PER DESIGN. PARAPET: RAILING: GALV. PIPES AS PER DESIGN.

NOTE: THE SCHEME HAS BEEN APPROVED IN 314th SCM HELD ON 17.5.2013 VIDE ITEM No. 92:2013

FOR FEASIBILITY ONLY

		PROJECT TITLE COMMUNITY HALL SRINIWASPURI	
DRC TITLE 1st, 2nd & 3rd FLOOR PLAN		SCH. NO. / DRWG. NO. 3	
SCALE	DATE		
ARCH. ASSTY.	ASST. ARCH.	ARCHITECT	
Sr. Architect	ADD. CH. ARCH.	CHIEF ARCHITECT	
HOUSING & URBAN PROJECTS WING VIKAS NUNAR, NEW DELHI-110002			

PRODUCED BY AN AUTODESK EDUCATIONAL PRODUCT



Socio-Cultural / सामाजिक सांस्कृतिक



DDA COMMUNITY HALL, SRINIWASPURI

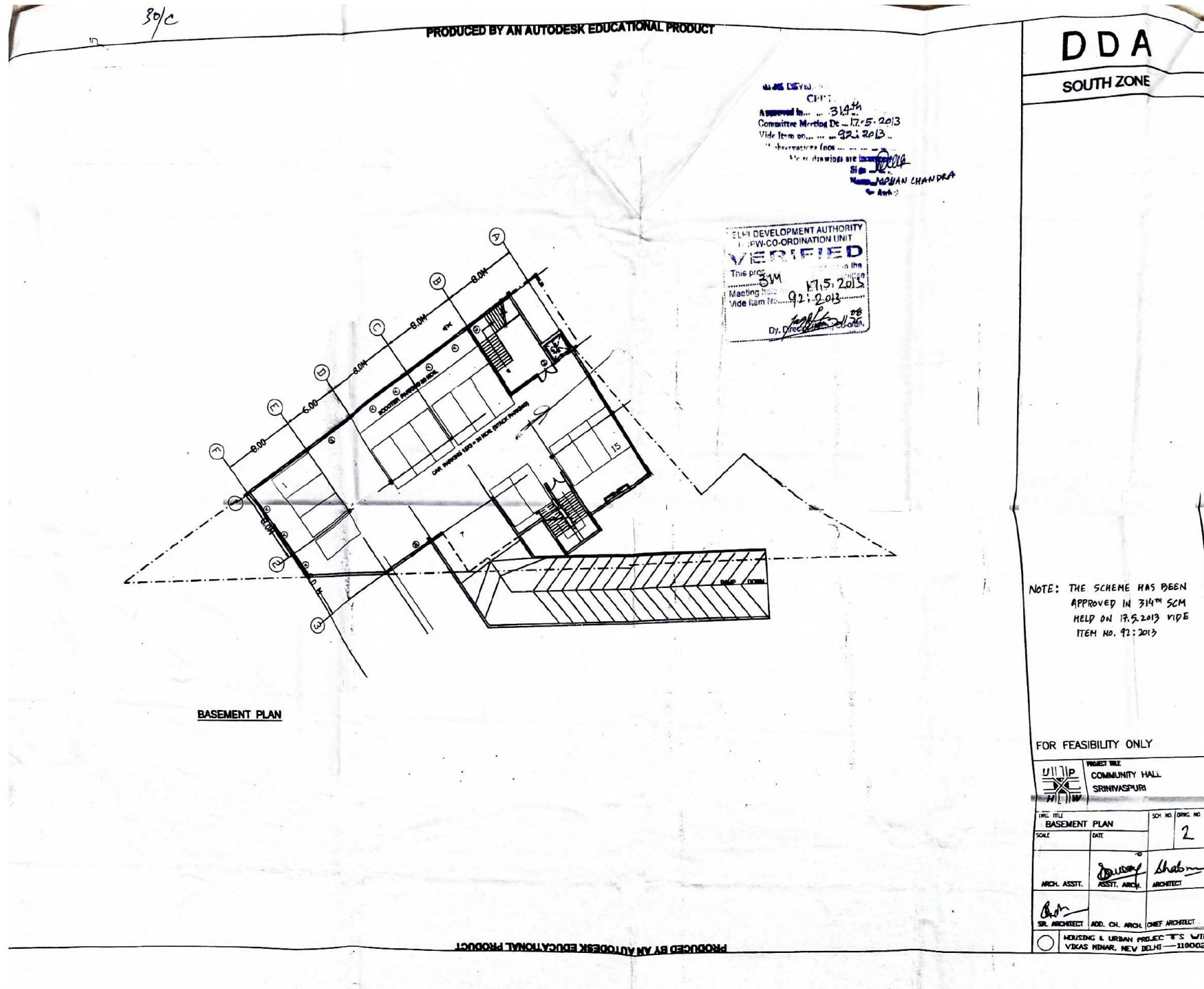

Socio-Cultural / सामाजिक सांस्कृतिक

