

# DDA COMMUNITY HALL, CS/OCF-1, Sector 19 ROHINI

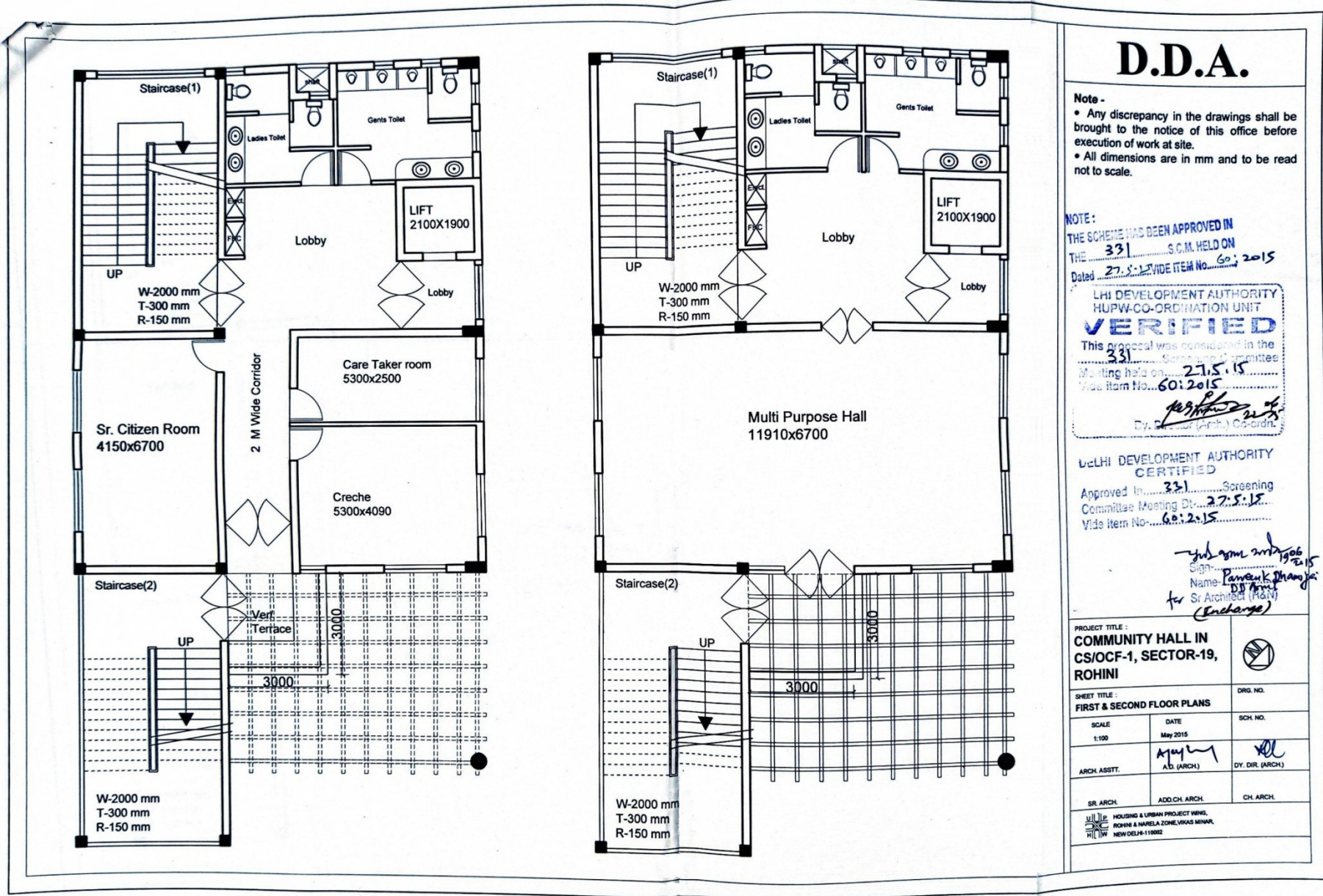

**D.D.A.**

**Note -**

- Any discrepancy in the drawings shall be brought to the notice of this office before execution of work at site.
- All dimensions are in mm and to be read not to scale.

**NOTE:**  
 THE SCHEME HAS BEEN APPROVED IN THE 331 S.C.M. HELD ON Dated 27.5.15 WIDE ITEM No. 60/2015

LHI DEVELOPMENT AUTHORITY HUPW-CO-ORDINATION UNIT  
**VERIFIED**  
 This proposal was considered in the 331 S.C.M. Meeting held on 27.5.15 Wide Item No. 60/2015

*[Signature]*  
 Dy. Secy (Arch.) Co-ordin.

**DELHI DEVELOPMENT AUTHORITY CERTIFIED**  
 Approved in 331 Screening Committee Meeting Dt. 27.5.15 Wide Item No. 60/2015

*[Signature]*  
 Name: Pankaj Dhanraj Sr. Architect (H.U.P.) (Encharge)

PROJECT TITLE : <b>COMMUNITY HALL IN CS/OCF-1, SECTOR-19, ROHINI</b>		DRG. NO.
SHEET TITLE : <b>FIRST &amp; SECOND FLOOR PLANS</b>		SCH. NO.
SCALE : 1:100	DATE : May 2015	
ARCH. ASSTT. : <i>[Signature]</i> A.D. (ARCH.)	DY. DIR. (ARCH.) : <i>[Signature]</i>	
SR. ARCH.	ADD. CH. ARCH.	CH. ARCH.

**DDA** HOUSING & URBAN PROJECTS WING, ROHINI & NARELA ZONE, VIKAS MINAR, NEW DELHI-110002



Socio-Cultural / सामाजिक सांस्कृतिक





# DDA COMMUNITY HALL, CS/OCF-1, Sector 19 ROHINI

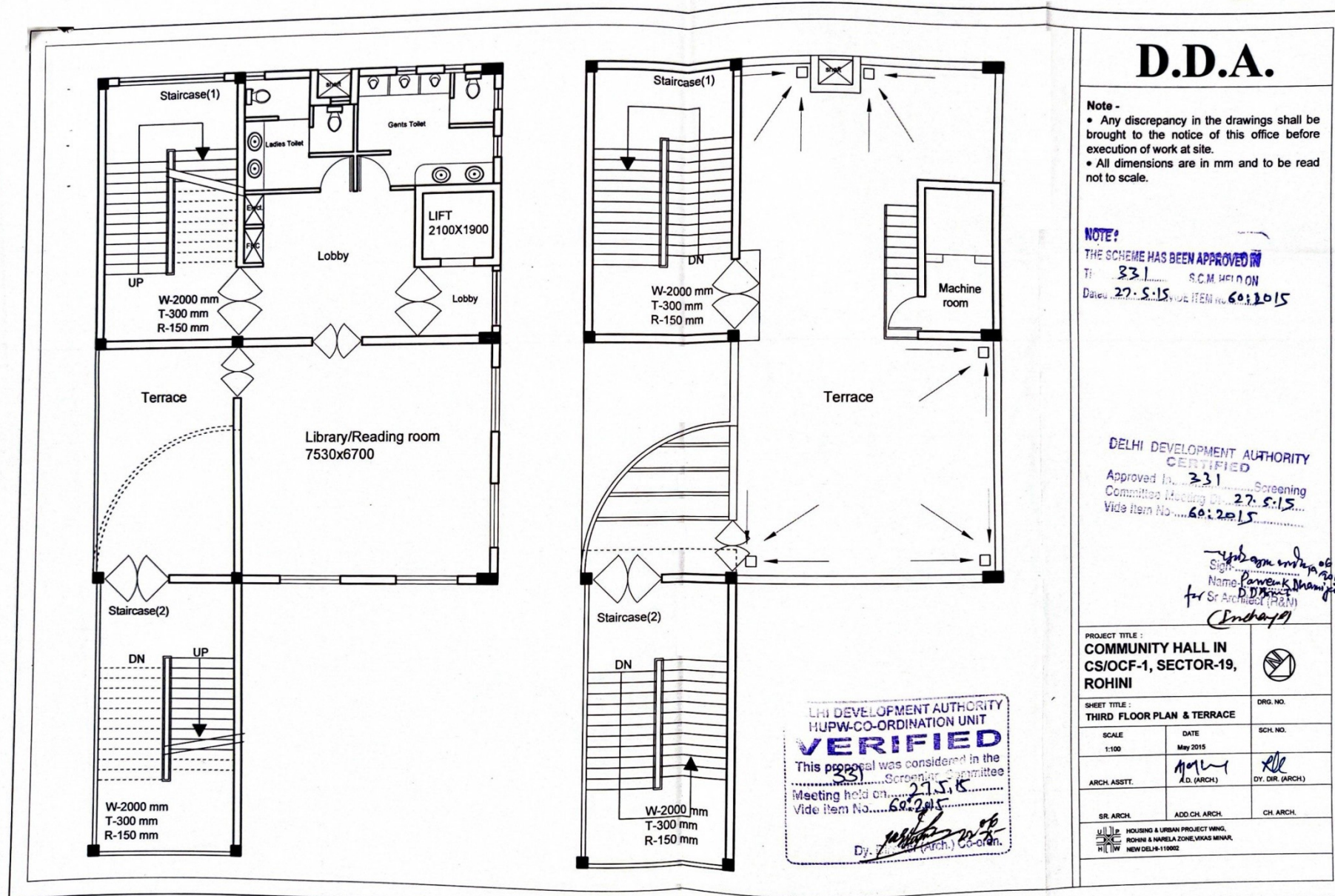



# DDA COMMUNITY HALL, CS/OCF-1, Sector 19 ROHINI

9/c

DELHI DEVELOPMENT AUTHORITY  
MUPW-CO-ORDINATION UNIT  
**VERIFIED**  
This proposal was considered in the  
331 Screening Committee  
Meeting held on 27.5.15  
vide Item No. 60/2015  
*[Signature]*  
Dy. Director (Arch.) Co-ordn.

**D.D.A.**

**Note -**

- Any discrepancy in the drawings shall be brought to the notice of this office before execution of work at site.
- All dimensions are in mm and to be read not to scale.

DELHI DEVELOPMENT AUTHORITY  
CERTIFIED

Approved in 331 Screening  
Committee Meeting Dt. 27.5.2015  
Vide Item No. 60/2015

*[Signature]*  
Name: *[Name]*  
for Sr Architect (R&N)  
(Incharge)

PROJECT TITLE: <b>COMMUNITY HALL IN CS/OCF-1, SECTOR-19, ROHINI</b>		
SHEET TITLE: NORTH EAST ELEVATION NORTH WEST ELEVATION		DRG. NO.
SCALE 1:200	DATE May 2015	SCH. NO.
ARCH. ASSTT. <i>[Signature]</i> AD. (ARCH)	<i>[Signature]</i> DY. DIR. (ARCH)	
Sr. ARCH.	ADD. CH. ARCH.	CH. ARCH.
<small>HOUSING &amp; URBAN PROJECTS WING, ROHINI &amp; NARELA ZONE, VKAS MINAR, NEW DELHI-110002</small>		

